

PERENNIALS

- P1** *Achillea millefolium*
Common Yarrow
Δ Many habitats
- P2** *Asclepias speciosa*
Showy Milkweed
Δ Many habitats; fields, roadsides
- P3** *Symphyotrichum chilense*
California Aster
Δ Grasslands, salt marshes, disturbed places
- P4** *Brickellia californica*
California Brickelbush
Δ Diverse dry habitats
- P5** *Camissonia cheiranthifolia*
Beach Evening Primrose
Δ Sandy slopes, flats, coastal dunes
- P6** *Carex spissa*
San Diego Sedge
Δ Waterways
- P7** *Eriogonum grande* E. Greene var. *rubescens*
Red Flowered Buckwheat
Δ Dry cliffs
- P8** *Eriogonum umbellatum*
Sulphur Flower Buckwheat
Δ Dry, open, often rocky places
- P9** *Fragaria vesca* L.
Woodland Strawberry
Δ Partial shade in forests
- P10** *Heracleum lanatum*
Cow Parsnip
Δ Moist places, wooded or open
- P11** *Mimulus aurantiacus* new name *Diplacus aurantiacus* ssp. *Aurantiacus*
Sticky Monkeyflower
Δ Cliffs, canyon slopes, borders of chaparral
- P12** *Mimulus cardinalis*
Cardinal Monkeyflower
Δ Moist to wet places near streams
- P13** *Monardella* sp.
Coyote Mint
Δ Rocky slopes, ephemeral drainages, oak woodland, chaparral, montane forest

P14 *Camissonia californica*
California Evening Primrose
Δ Sandy / gravelly areas, dunes, desert scrub to pinon / juniper or ponderosa woodlands

P15 *Satureja douglasii*
Yerba Buena
Δ Shady places, chaparral, woodland

P16 *Sidalcea malviflora*
Checker Bloom, Checker Mallow
Δ Dry places in forest or scrub

P17 *Sisyrinchium bellum*
Blue-Eyed Grass
Δ Open, generally moist, grassy areas, woodlands

P18 *Iris* sp.
Fernald's Iris
Δ Shady places

P19 *Dudleya* sp.
Dudleya
Δ Rocky outcrops, slopes

P20 *Asarum caudatum*
Wild Ginger
Δ Moist places in forests

P21 *Lilium pardalinum* ssp.
Tiger Lily
Δ Moist places, streambanks, along coast

P22 *Eriophyllum staechadifolium*
Seaside Woolly Sunflower/Lizard Tail
Δ Coastal Strand, Coastal Sage Scrub

P23 *Perideridia kelloggii*
Yampah
Δ Open grassland, serpentine outcrops

P24 *Delphinium cardinale*
Scarlet Larkspur
Δ Slopes (often talus) in chaparral

P27 *Wyethia angustifolia*
Narrow leaf Mule ears
Δ Grassland

P28 *Heuchera micrantha*
Alum Root
Δ Moist, rocky banks and cliffs

P29 *Armeria maritima*
Sea Pink
Δ Ocean bluffs, ridges, coastal strand, sand, exposed grasslands

P30 *Epilobium 'Everett's Choice'*
Prostrate CA fuchsia
Δ Sun, occasional watering

P25 *Eriogonam elongatum*
Long stemmed Buckwheat
Δ Dry places

P26 *Helenium puberulum*
Rosilla, Sneezeweed
Streamsides, marshes, other wetlands

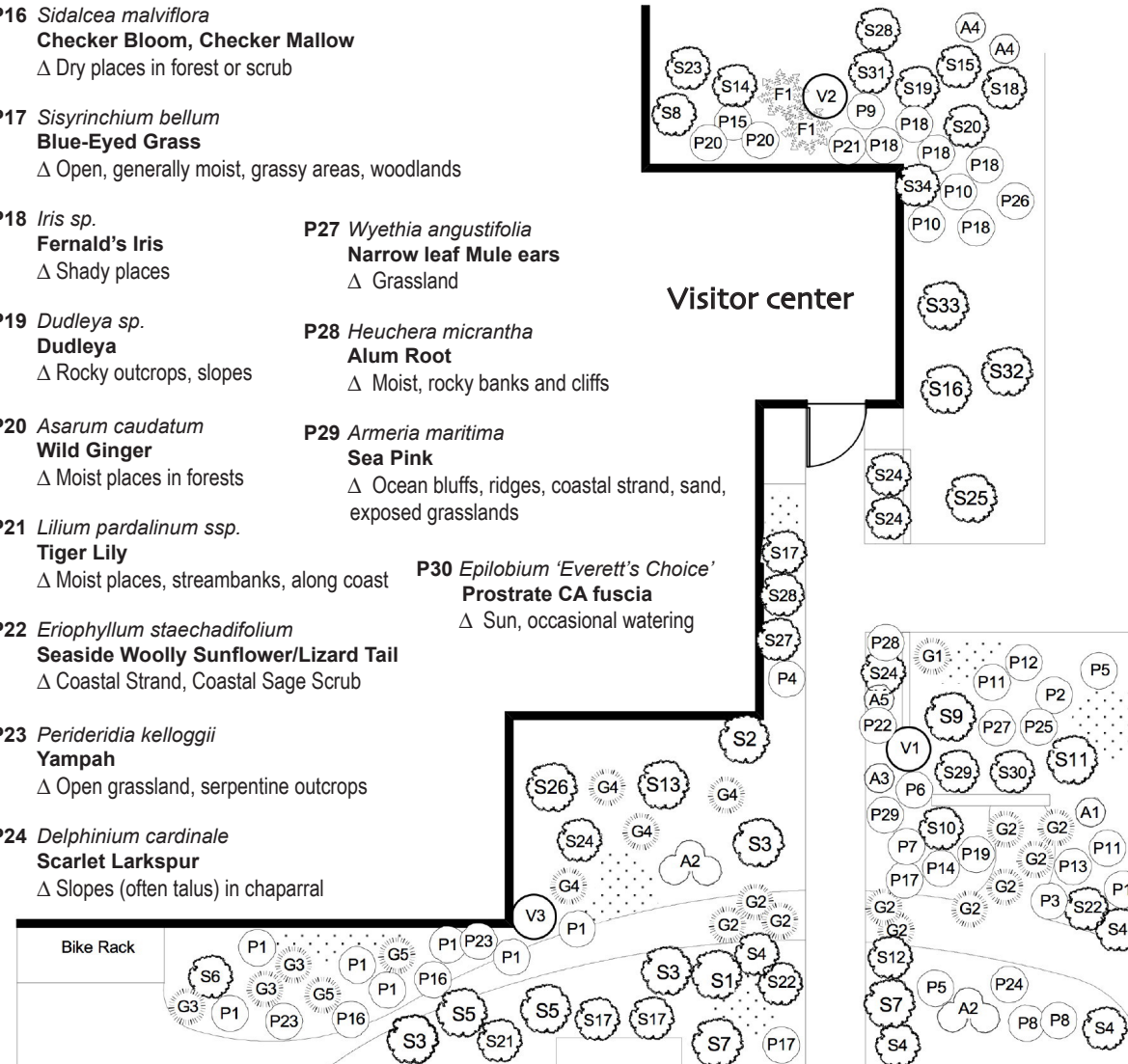

This brochure is produced in memory of Ray Egbert, dedicated volunteer and lover of California's native plants and Susan Holland, long-time John Muir Association board member.

John Muir National Historic Site California Native Plant Garden



Vaccinium ovatum (California Huckleberry)

John Muir had an abiding passion for California's native flora. We hope to inspire that same passion in those who "saunter" through the garden. Enjoy and take the time to learn the names and growing conditions of some of the state's most beautiful trees, shrubs, perennials, and grasses.

A COLLABORATION OF:

- Adaptive Horticulture Department @ DVC
 - Annie's Annuals
 - Berkeley Horticultural Nursery
 - California Native Plant Society, East Bay
- Garden designed and implemented by Californica Landscapes, Greg Wolford, Owner
 - Contra Costa Master Gardeners
 - Contra Costa RCD
- Creative Exteriors Landscape Design
 - Friends of Alhambra Creek
 - John Muir Association
 - National Park Service
 - Urban Farmer
 - Watershed Nursery

PLANT LIST

△ HABITAT PREFERENCE is noted to assist you in selecting plants that will thrive in your garden. The information is drawn from the **Jepson Manual: Higher Plants of California**. The Jepson Herbarium's website is ucjeps.berkeley.edu. You'll also find an abundance of information on California natives at the **CalFlora** website, www.calflora.org.

SHRUBS

- S1** *Arctostaphylos manzanita_x_densiflora* 'Austin Griffith'
Austin Griffith's Manzanita
△ Oak Woodland, chaparral and coastal sage scrub
- S2** *Arctostaphylos sp.*
Manzanita
△ Oak Woodland, chaparral and coastal sage scrub
- S3** *Artemisia californica*
California Sagebrush
△ Coastal scrub, chaparral, dry foothills, especially near coast
- S4** *Baccharis pilularis* 'Pigeon Point'
Dwarf Coyote Brush, Dwarf Chaparral Broom
△ Coastal bluffs to oak woodland
- S5** *Ceanothus hearstiorum*
Hearst Ranch Buckbrush
△ Coastal, low, grassy hills
- S6** *Ceanothus arboreus x griseus* 'Ray Hartman'
Mountain Lilac
△ Dry shrubby slopes. chaparral, coastal scrub
- S7** *Ceanothus maritimus*
Ceanothus
△ Chaparral, coastal scrub
- S8** *Corylus cornuta* Marsh. var. *californica*
California Hazelnut
△ Many habitats, especially moist, shady places
- S9** *Dendromecon harfordii*
Island Bush Poppy
△ Shrubby slopes
- S10** *Eriogonum cinereum*
Oakleaf Buckweat
△ Beaches, coastal bluffs

- S11** *Eriogonum fasciculatum*
California Buckwheat
△ Dry slopes, washes, canyons in scrub
- S12** *Eriogonum sp.*
Santa Cruz Island Buckwheat
△ Dry slopes
- S13** *Arctostaphylos viridissima* 'White Cloud'
White Cloud McMinn's Manzanita
△ Shale outcrops, chaparral, coniferous
- S14** *Heteromeles arbutifolia*
Toyon, Christmas Berry
△ Chaparral, oak woodland, mixed-evergreen forest
- S15** *Holodiscus discolor*
Cream Bush
△ Moist woodland edges, rocky slopes
- S16** *Rhamnus californica*
California Coffeeberry, Leatherleaf
△ Coastal-sage scrub, chaparral, woodlands, forests
- S17** *Ribes aureum*
Golden Currant
△ Many habitats
- S18** *Ribes menziesii*
Gooseberry
△ Forest openings, chaparral
- S19** *Ribes sanguineum v. glutinosum* 'Inverness White'
White Flowering Currant
△ Many habitats
- S20** *Rosa californica*
California Wild Rose
△ Moist areas, streambanks
- S21** *Salvia apiana*
White Sage
△ Dry slopes, coastal-sage scrub, chaparral, yellow-pine forest
- S22** *Salvia clevelandii*
Cleveland Sage
△ Chaparral, dry slopes, coastal scrub
- S23** *Sambucus nigra ssp. Canadensis*
Blue Elderberry
△ Streambanks, open places in forest
- S24** *Vaccinium ovatum*
California Huckleberry
△ Edges, clearings in coniferous woods

- S25** *Mahonia aquifolium* 'John Muir' new name
Berberis aquifolium (loosely) **Oregon grape**
△ Slopes, canyons, coniferous forest, oak woodland, chaparral
- S26** *Fremontodendron sp.*
California Flannelbush
△ Chaparral, oak/pine woodland, rocky ridges
- S27** *Mimulus aurantiacus*
sticky monkeyflower
△ Rocky hillsides, cliffs, canyon slopes, borders of chaparral
- S28** *Ribes sanguineum* 'Barrie Coate'
NA
△ Many habitats
- S29** *Salvia munzii*
Munz's sage
△ Coastal-sage scrub, lower chaparral
- S30** *Ceanothus maritimus* 'Frosty Dawn'
Maritime ceanothus
△ Coastal hills, bluffs
- S31** *Symphoricarpos albus*
Snowberry
△ Shady woods, streambanks, north slopes
- S32** *Rhamnus crocea ssp. 'illicifolia'*
Hollyleaf coffeeberry
△ Coastal-sage scrub, chaparral, woodlands
- S33** *Cercis occidentalis*
Western redbud
△ Dry, shrubby slopes, canyons, ravines, streambanks, chaparral, foothill woodlands to yellow-pine forest
- S34** *Cercocarpus betuloides*
Mountain mahogany
△ Chaparral, pine/oak woodland, coniferous forest
- ### VINES
- V1** *Aristolochia californica*
California Pipevine
△ Streamsides, forest, chaparral
- V2** *Lonicera sp.*
Honeysuckle
△ Moist places
- V3** *Vitis girdiana*
Desert wild grape
△ Streamsides, canyon bottoms

ANNUALS

- A1** *Eriophyllum ambiguum*
Annual Woolly Sunflower
△ Woodland, desert
- A2** *Eschscholzia californica*
California Poppy
△ Grassy, open areas
- A3** *Stylomecon heterophylla*
Wind Poppy
△ Grassy areas, openings in chaparral
- A4** *Juncus bufonius*
Toad Rush
△ Moist (sometimes saline) open/disturbed places
- A5** *Clarkia rubicunda*
Farewell to Spring
△ Openings, woodland, forest, chaparral near coast

FERNS

- F1** *Athyrium (sp)*
Lady Fern
△ Moist or wet rock crevices, talus, cliffs, boulder bases, streamsides

GRASSES

- G1** *Calamagrostis nutkaensis*
Pacific Reed Grass
△ Wet areas, beaches, dunes, coastal woodland
- G2** *Deschampsia cespitosa ssp. holciformis* (Jughandle Creek Dwarf)
Coastal Tufted Hair-grass
△ Coastal marshes and meadows
- G3** *Bromus carinatus*
California Broome
△ Open scrub, woodland, forest
- G4** *Festuca rubra*
Red Fescue
△ Sand dunes, grassland, subalpine forest
- G5** *Nassella pulchra*
Purple Needlegrass
△ Oak woodland, chaparral, grassland

